

ISSUE

Issued for Permit
08.05.2016

PROJECT: 16-018

Hampton Inn & Suites

New Stanton, PA 15672

OWNER

Stanton Hospitality LLC

52 Blueberry Lane,
Grove City, PA 16127

THESE DRAWINGS ARE FOR REVIEW OF DESIGN AND SCOPE DESCRIPTION ONLY. NO REPRESENTATION IS MADE TO THE ACCURACY OF THE DRAWINGS WITH REGARD TO EXISTING DIMENSIONS OR CONDITIONS. ALL CONSULTANTS AND CONTRACTORS MUST VERIFY ANY AND ALL DIMENSIONS AND CONDITIONS WHICH ARE CRITICAL TO THEIR WORK. THESE DRAWINGS ARE INSTRUMENTS OF SERVICE AND ARE THE INTELLECTUAL PROPERTY OF JMAC ARCHITECTS. ANY UNAUTHORIZED USE OR REPRODUCTION IS PROHIBITED.

[illegible]

No.	Issue Date	Project Status
-----	------------	----------------

Enlarged Guestroom
Plans and Elevations -
Accessible Double
Queen

As indicated

A-527

GUEST ROOM PLAN NOTES

1. REFER TO LAYOUT DRAWINGS FOR ADDITIONAL DIMENSIONAL INFORMATION
2. REFER TO SCHEDULE FOR PARTITION TYPES, SEE CORRESPONDING TAGS FOR ENLARGED ROOM PLANS, PARTITIONS AND DETAILS
3. PROVIDE 4" CRITICAL DIMENSIONS BETWEEN DOOR OPENING AND WALL AT HINGE SIDE, U.N.O.
4. PROVIDE 18" CRITICAL DIMENSIONS BETWEEN DOOR OPENING AND ALL OBSTRUCTIONS AT PULL SIDE OF DOOR.
5. PROVIDE 12" CRITICAL DIMENSION BETWEEN DOOR OPENING AND ALL OBSTRUCTIONS AT PUSH SIDE OF DOOR
6. WALLS BETWEEN ADJACENT ROOMS - ELECTRICAL OUTLET, LIGHTING, TELEPHONE TV AND TELEPHONE OUTLETS, SHALL BE OFFSET 6" MIN. HORIZONTALLY - BACK TO BACK OUTLETS ARE NOT ALLOWED
7. COMMUNICATION FEATURE ROOM MUST HAVE A VISIBLE NOTIFICATION DEVICE FOR THE TELEPHONE.
8. ACCESSIBLE ROOMS SHALL BE EQUIPPED WITH TOGGLE - TYPE SWITCHES
9. PROVIDE ADEQUATE F.R.T. BLOCKING AT ALL PARTITIONS TO HAVE WALL MOUNTED COUNTER, MILLWORK, OR SHELVING TO ACCOMMODATE MAXIMUM LOADING. COORDINATE LOCATION OF BLOCKING FOR ARCHITECTURAL AND MEP EQUIPMENT AS REQUIRED.
10. COORDINATE SMOKE, STROBE, THERMOSTAT, AND FIRE EXTINGUISHER LOCATIONS SO AS TO AVOID FURNITURE PANELS, ACCESSORY WALL PANELS, SCREENS CASEWORK AND WALL CABINETS.
11. REFER TO SCHEDULE FOR DOOR TYPES AND HARDWARE.

POWER PLAN SYMBOLS

PLAN	ELEV	
		DUPLEX OUTLET
		QUADPLEX OUTLET
		GFI OUTLET
		TELEPHONE OUTLET
		TV OUTLET
		SWITCH
		REMOTE THERMOSTAT
		SMOKE DETECTOR
		STROBE (IN C.F. ROOMS ONLY)
		FIRE HORN/STROBE (IN C.F. ROOMS ONLY, OMIT FIRE HORNS WHEN THESE ARE USED)
		FIRE HORN (NON-C.F. ROOMS)
		SIDEWALL SPRINKLER HEAD
		DOORBELL LIGHT (C.F. ROOMS ONLY)
		HSIA (WIRED WHERE APPLICABLE)
		JUNCTION BOX
		EXHAUST FAN
		LIGHT AT CEILING
		DOORBELL - MOUNT AT 48" AFF TO CENTER OF BUTTON (C.F. ROOMS ONLY)

GUESTROOM KEYNOTES

- 1 HARDWIRED PACKAGED TERMINAL AIR CONDITIONER (PTAC) UNIT.
- 2 EXTERIOR WINDOW AND ASSOCIATED TREATMENTS
- 3 BARN DOOR ON EXPOSED HARDWARE - REFER TO DOOR SCHEDULE FOR MIRROR INSIDE APPLICATION
- 4 COMMUNICATING DOOR LOCATION WHEN USED
- 5 ARCHITECTURAL MILLWORK VALANCE PAINT TO MATCH GENERAL WALL COLOR. ANCHOR FROM CEILING
- 6 LIGHTS IN THIS AREA MUST BE DAMP LOCATION RATED W/ HATTER PROOF LENSES
- 7 WALL MOUNTED VANY LIGHT - PROVIDE JUNCTION BOX, COORDINATED WITH FIXTURE
- 8 STARTING POINT OF TILE - BEGIN WITH FULL TILE
- 9 ALL ROOMS TO HAVE HSIA PER HILTON STANDARDS. IF HARDWIRED INTERNET ACCESS IS DESIRED, A RECEPTACLE MUST BE PLACED @ 34" A.F.F.
- 10 SHOWER / BATH DRAIN LOCATION
- 11 NO FINISHES UNDER SHOWER PAN / TUB
- 12 PROVIDE DEDICATED ELECTRICAL CIRCUIT FOR EACH UNDERCOUNTER APPLIANCE
- 13 DOORBELL ON/OFF SWITCH FOR COMMUNICATION FEATURE ROOM ONLY - SIGNAGE AS REQUIRED
- 14 THRESHOLD - REFER TO STANDARDS MANUAL
- 15 SHOWER INDICATED. BATH TUBS MAY BE SUBSTITUTED - REFER TO STANDARDS
- 16 DASHED BOXES AND CIRCLES REPRESENT ACCESSIBLE PLANS FOR ADDITIONAL INFORMATION
- 17 ACCESSIBLE DRAPEY CONTROL
- 18 DESK MUST PROVIDE MIN. 30" WIDE CLEAR FLOOR SPACE AND A MIN. 27" HIGH KNEE CLEARANCE
- 19 PROVIDE DRAIN IN THIS LOCATION IN GUEST BATHS EQUIPPED WITH ROLL-IN SHOWERS. DISH DRAIN AT 6" RADIUS (1.48 SLOPE MAX.) PROVIDE TRAP PRIMER
- 20 FLAT SCREEN TV
- 21 REFRIG
- 22 TELEPHONE
- 23 CENTER SCENE ABOVE NIGHTSTAND
- 24 EDGE OF PTAC SKIRT AT FLOOR













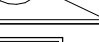



FURNISHING LEGEND

- GF-100 ACTIVITY CHAIR
- GF-101 OTTOMAN
- GF-102 SOFA SLEEPER
- GF-103 SINGLE ARM SOFA SLEEPER
- GF-104 SINGLE ARM CHAIR
- GF-105 LOUNGE CHAIR
- GF-201 GUESTROOM VANITY LIGHT
- GF-202 BEDSIDE TABLE LAMP AT NIGHTSTAND
- GF-203 SINGLE NIGHTSTAND SCONCE
- GF-204 DOUBLE NIGHTSTAND SCONCE
- GF-205 DESK LAMP
- GF-206 FLOOR LAMP
- GF-300 STREAMLINE UNIT
- GF-301 KING HEADBOARD
- GF-302 QUEEN HEADBOARD
- GF-303 DOUBLE HEADBOARD
- GF-304 NIGHTSTAND
- GF-305 NIGHTSTAND WITH POWER
- GF-306 DOUBLE NIGHTSTAND WITH POWER
- GF-307 C-TRAB
- GF-308 68" VANITY AT GUEST BATH
- GF-309 68" VANITY AT GUEST BATH
- GF-310 ADA VANITY AT GUEST BATH
- GF-311 STREAMLINE DIVIDER UNIT
- GF-312 ADA STREAMLINE DIVIDER UNIT
- GF-313 ADA STREAMLINE DIVIDER UNIT
- GF-314 42" VANITY AT GUESTBATH
- GF-315 STREAMLINE DESK UNIT
- GF-400 WINDOW TREATMENT WITH PTAC
- GF-401 WINDOW TREATMENT WITHOUT PTAC
- GF-402 ROLLER SHADE
- GF-500 ARTWORK AT GUESTROOM
- GF-501 ARTWORK AT GUEST BATH
- GF-502 ARTWORK AT SOFA IN SUITES
- GF-503 FRAMED MIRROR AT VANITY
- GF-504 FRAMED MIRROR AT ADA VANITY
- GF-600 KING BED BASE
- GF-601 KING MATTRESS SET
- GF-602 KING BEDDING SET
- GF-603 ADA KING BED BASE
- GF-604 QUEEN BED BASE
- GF-605 QUEEN MATTRESS SET
- GF-606 QUEEN BEDDING SET
- GF-607 ADA QUEEN BED BASE

FINISH LEGEND

B	BASE	NOTE:
C	CARPET	REFER TO FF&E SPECIFICATIONS
MIR	MIRROR	MANUAL AND COLOR AND
PT	PAINT	MATERIALS SPECIFICATIONS
ST	STONE	MANUAL FOR FURNITURE ITEMS
SF	SPECIAL FINISH	NOT IDENTIFIED WITHIN THESE
T	TILE	DRAWINGS
VCT	VINYL COMPOSITE TILE	
WC	WALL COVERING	
WD	WOOD FINISH	

CEILING LEGEND

	RECESSED LIGHT
	RECESSED ADJUSTABLE DOWN LIGHT FIXTURE
	RECESSED FLUORESCENT LIGHT FIXTURE 24" x 48"
	RECESSED FLUORESCENT LIGHT FIXTURE 24" x 24"
	SURFACE MTD. FLUORESCENT LIGHT FIXTURE 24" x 48"
	WALL MOUNTED LIGHT SCONCE
	PENDANT LIGHT FIXTURE
	DECORATIVE PENDANT LIGHT FIXTURE
	DIRECTIONAL EMERGENCY EXIT LIGHT
	BATH EXHAUST FAN
	RECESSED SHOWER DOWNLIGHT
	LINEAR DIFFUSER
	RETURN AIR GRILLE
	DIFFUSER
	WALL MOUNTED SPRINKLER
	CEILING SPRINKLER

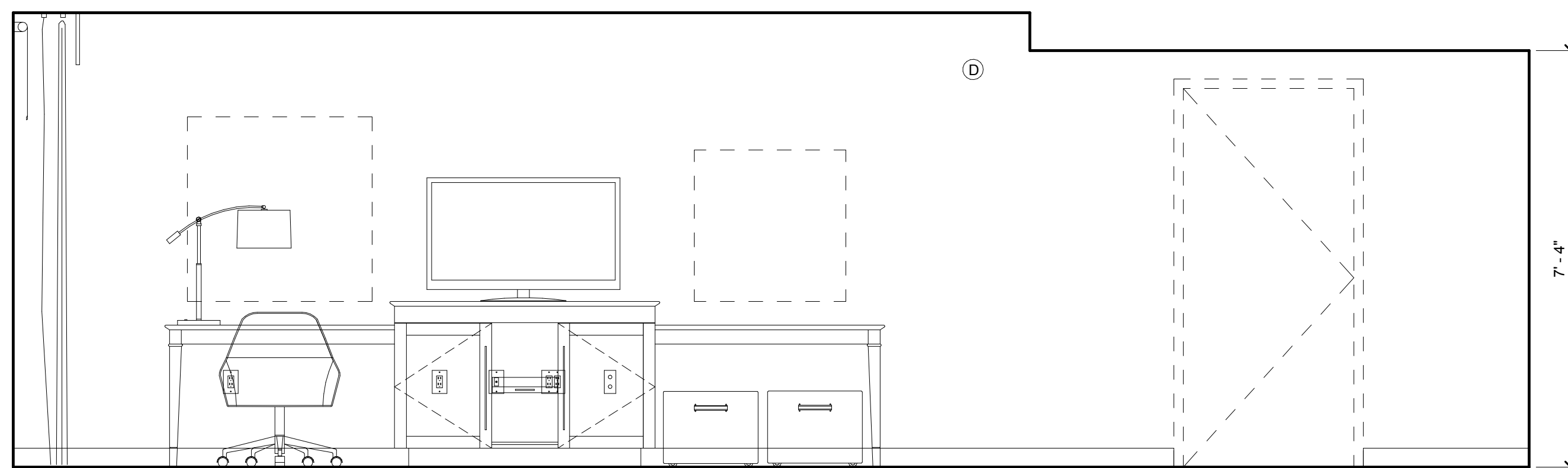

4 Interior Elevation
1/2" = 1'-0"

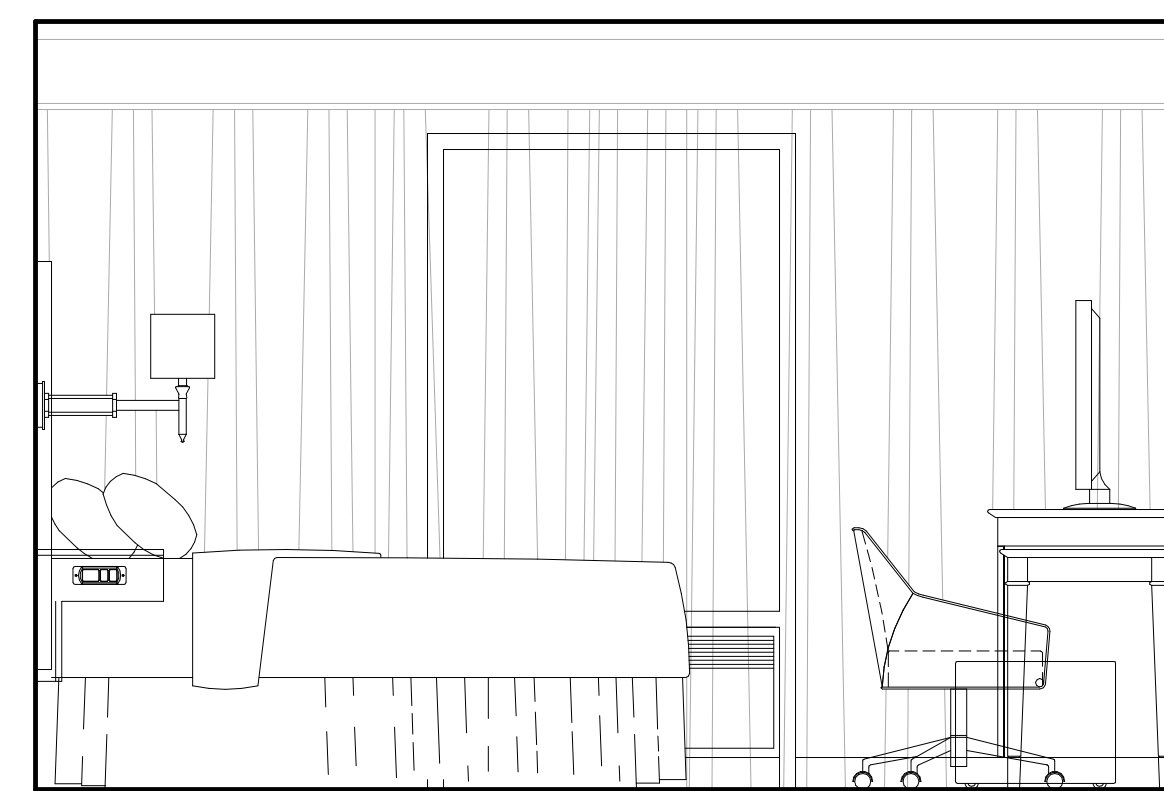

5 Interior Elevation
1/2" = 1'-0"

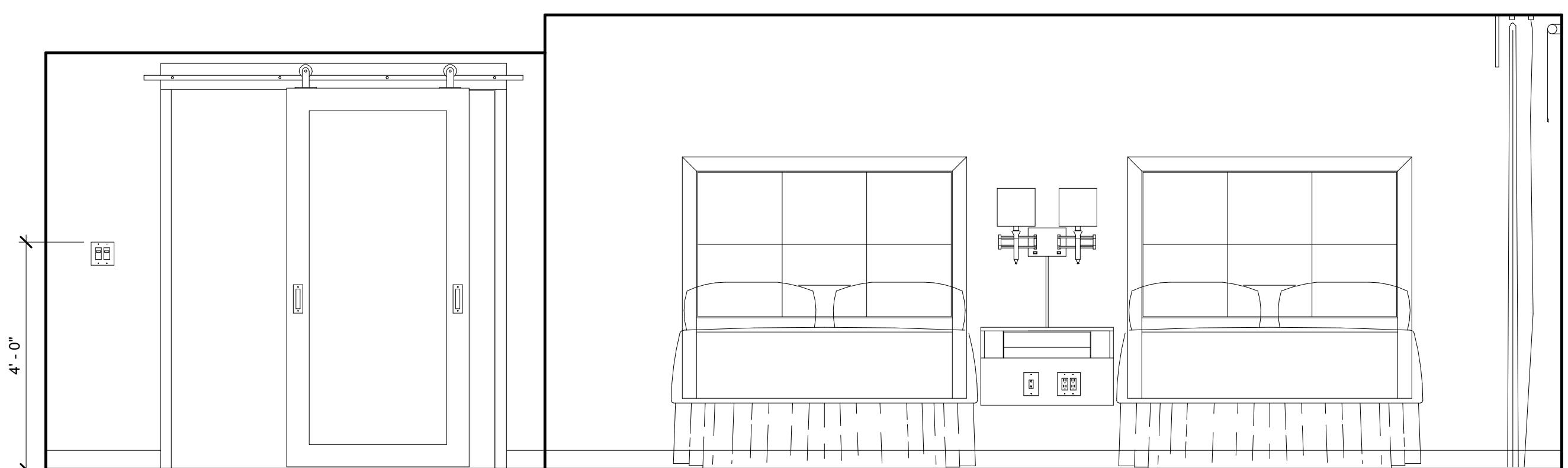

6 Interior Elevation
1/2" = 1'-0"

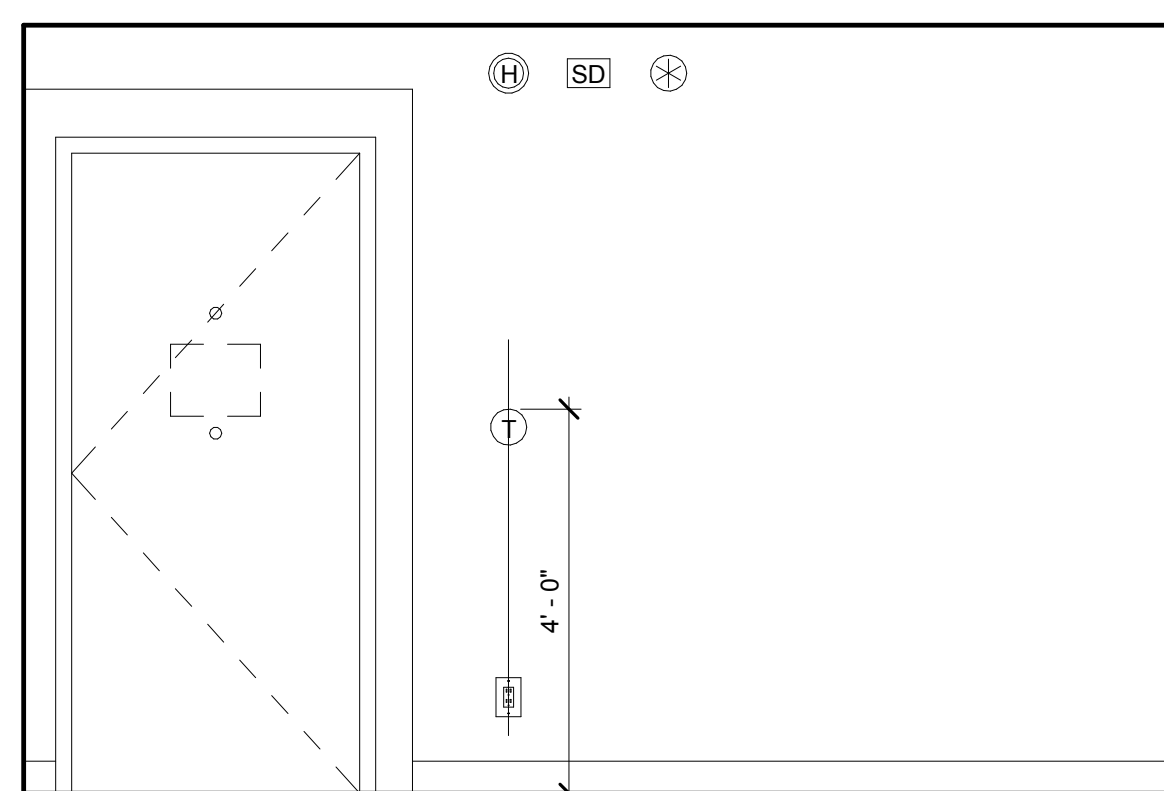

7 Interior Elevation
 $\frac{1}{2}'' = 1'-0''$

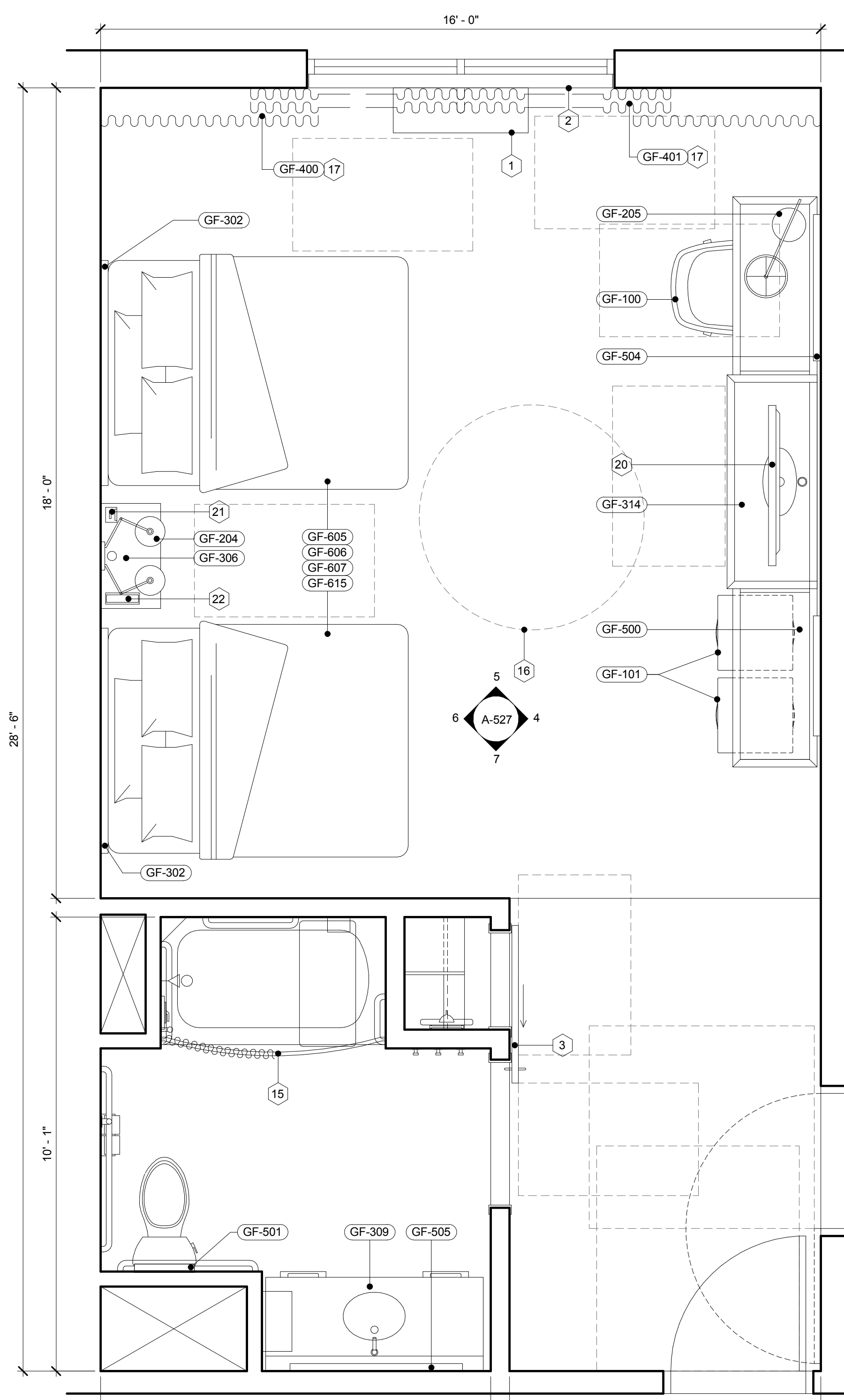

1 Enlarged ADA Double Queen Floor Plan
1/2" = 1'-0"

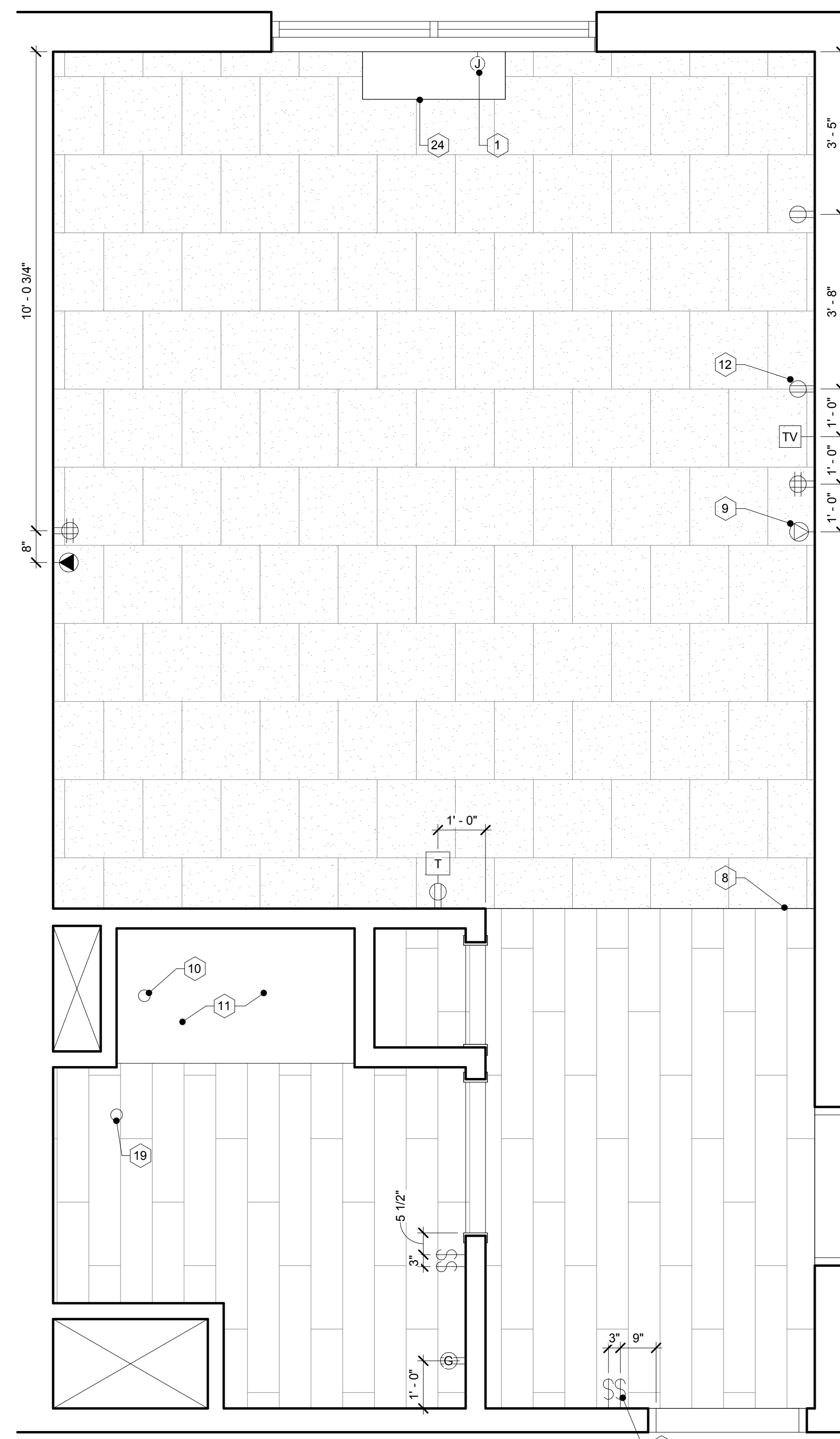

2 Enlarged Finish Floor Plan
1/2" = 1'-0"

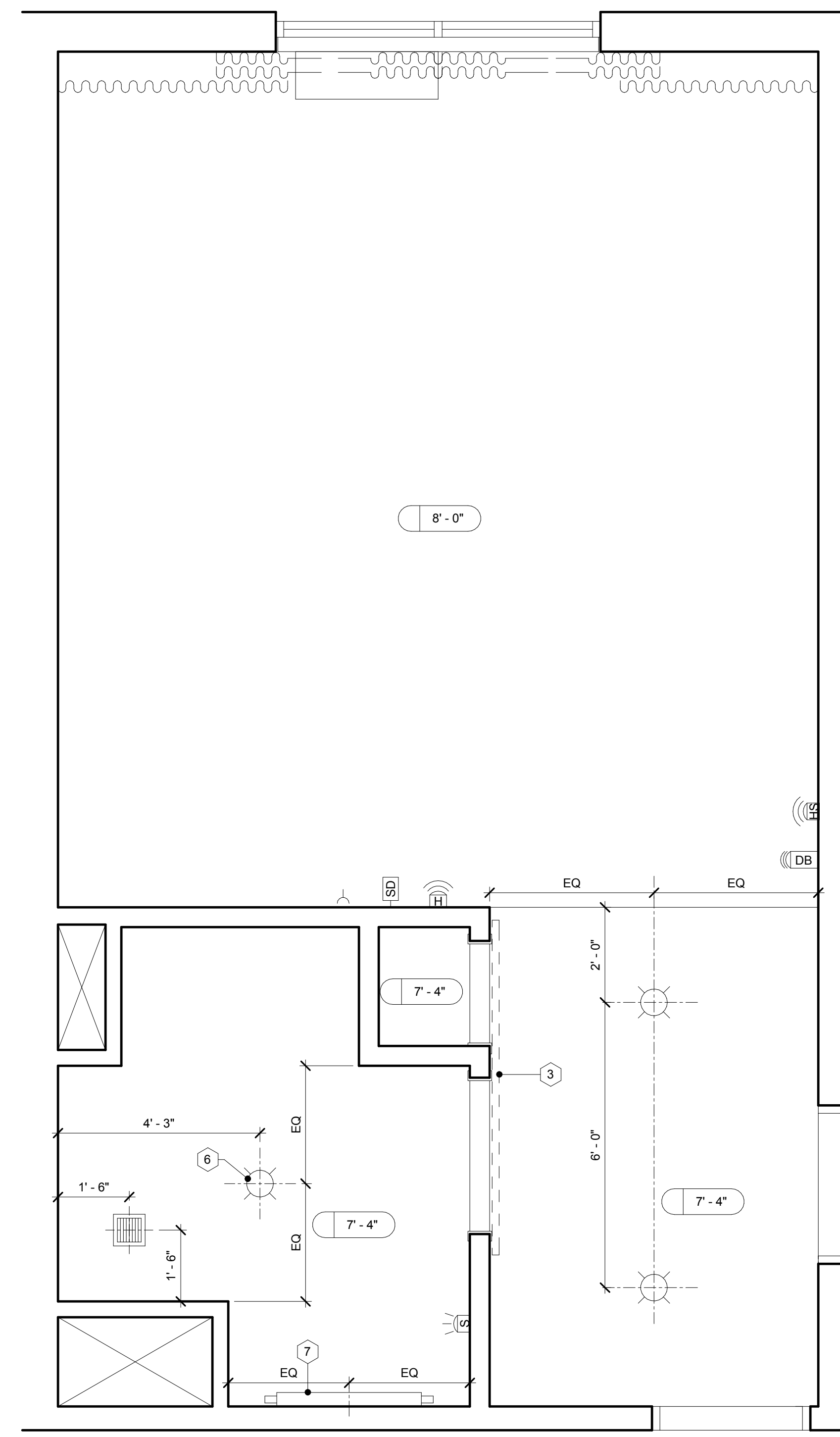

3 Enlarged Reflected Ceiling Plan
1/2" = 1'-0"